

**Front View**

C : Available for min. 1200mm height and vertical model.

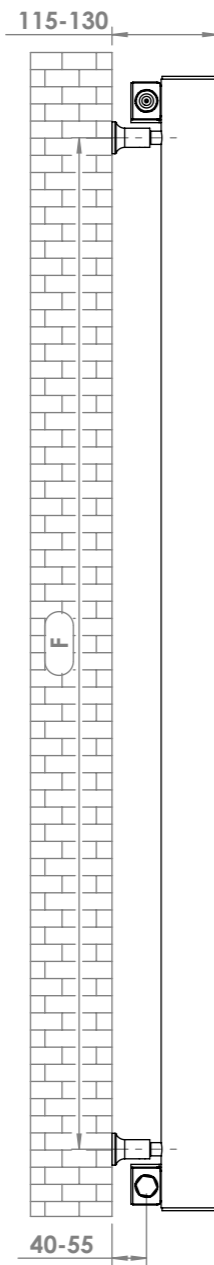

**Side View**

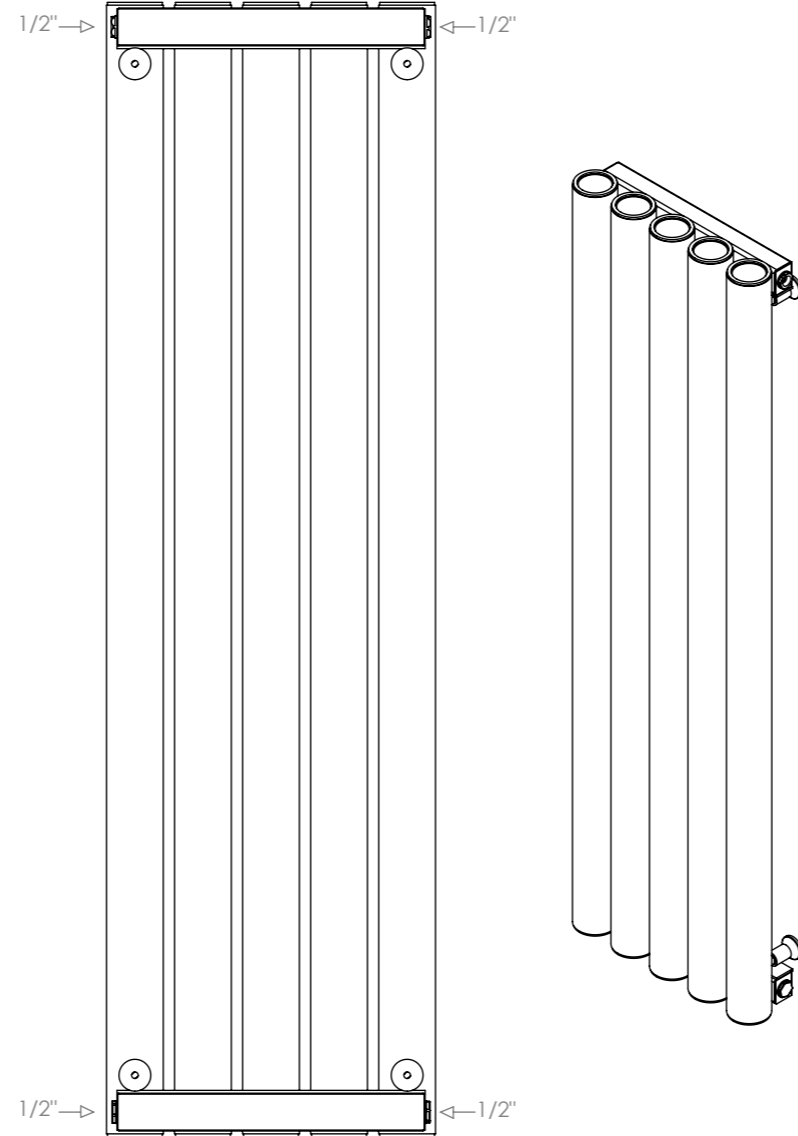

**Back View**

1/2" (Available for min. 1200mm height and vertical model)

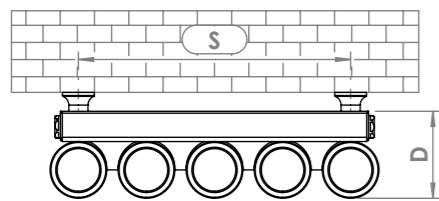

**Top View**

**Installation Accessories:**

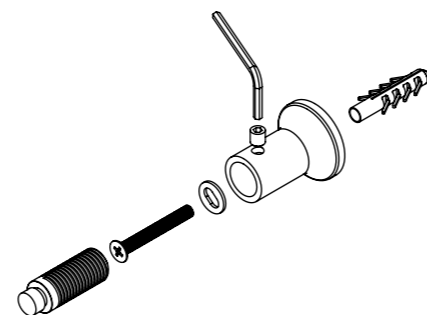
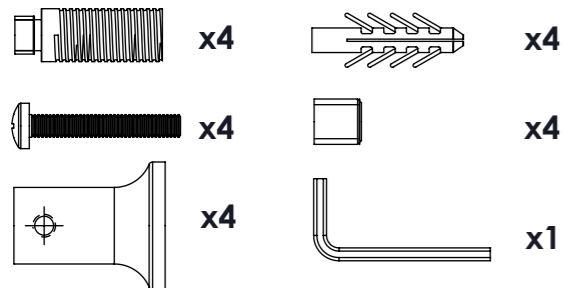

**Plumbing Position: Horizontal**

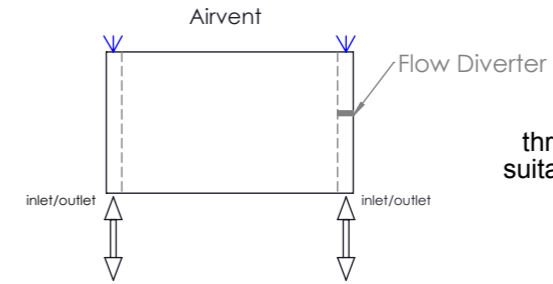

When mounting horizontally, please knock through the centre hole of the diverter using a suitable rod. Please remove the disk if it comes loose and can be removed from a tapping

**Plumbing Position: Vertical**

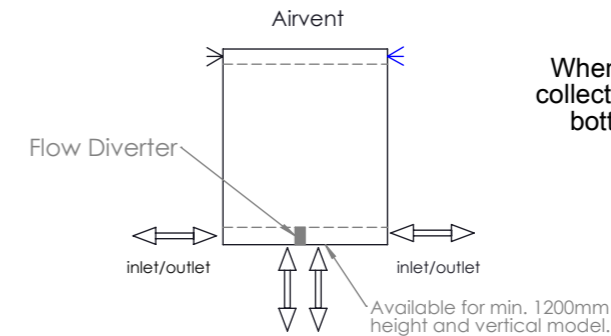

When mounting vertically, please observe that the collector fitted with a flow diverter is mounted at the bottom. This can be verified by visually checking or by referring to the installation diagram

Vertical / Horizontal mount  
All Dimensions are in mm  
Max.Working Pressure: 10 Bar  
Max.Working Temperature: 95° C  
Inlet / Outlet : 1/2" BSP  
Fuel : E/H/D

PRODUCT CODE	Height	Length	Depth	Pipe Centres	Bracket Centres	
	H mm	L mm	D mm	C-C1 mm	F mm	S mm
<b>MYSTIC - Horizontal</b>						
MYE405	400	340	90	280-410	270	280
MYE406	400	410	90	350-480	270	350
MYE407	400	480	90	420-550	270	420
MYE408	400	550	90	490-620	270	490
MYE409	400	620	90	560-690	270	560
MYE410	400	690	90	630-760	270	630
MYE412	400	830	90	770-900	270	770
MYE414	400	970	90	910-1040	270	910
MYE416	400	1110	90	1050-1180	270	1050
MYE605	600	340	90	280-410	470	280
MYE606	600	410	90	350-480	470	350
MYE607	600	480	90	420-550	470	420
MYE608	600	550	90	490-620	470	490
MYE609	600	620	90	560-690	470	560
MYE610	600	690	90	630-760	470	630
MYE612	600	830	90	770-900	470	770
MYE614	600	970	90	910-1040	470	910
MYE616	600	1110	90	1050-1180	470	1050
<b>MYSTIC - Vertical</b>						
MYE154	1500	270	90	50-340	1370	210
MYE155	1500	340	90	50-410	1370	280
MYE156	1500	410	90	50-480	1370	350
MYE158	1500	550	90	50-620	1370	490
MYE184	1800	270	90	50-340	1670	210
MYE185	1800	340	90	50-410	1670	280
MYE204	2000	270	90	50-340	1870	210
MYE205	2000	340	90	50-410	1870	280
MYE206	2000	410	90	50-480	1870	350
MYE207	2000	480	90	50-550	1870	420
MYE208	2000	550	90	50-620	1870	490