

MYSTIC L

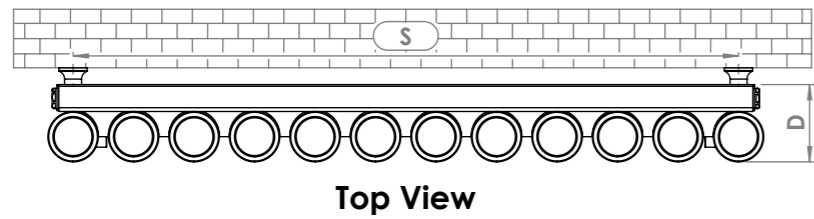

Plumbing Position:

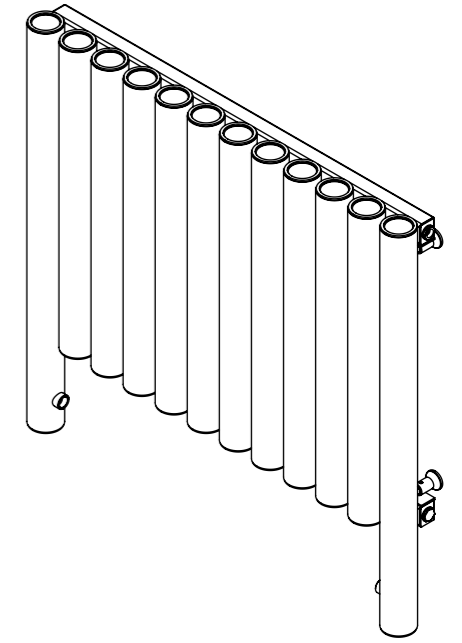
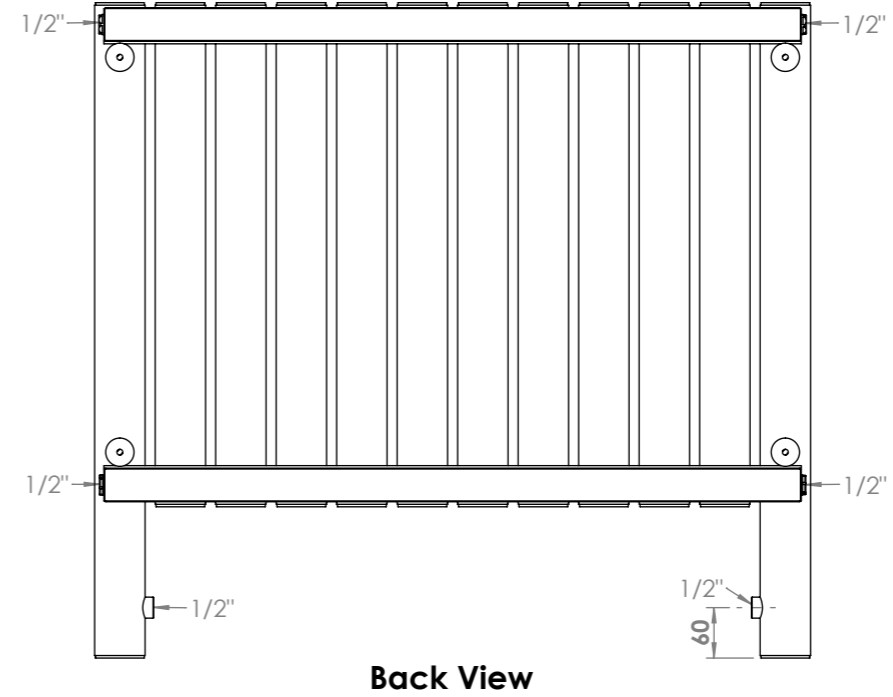
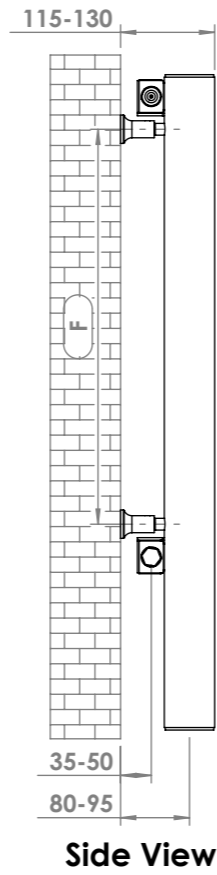
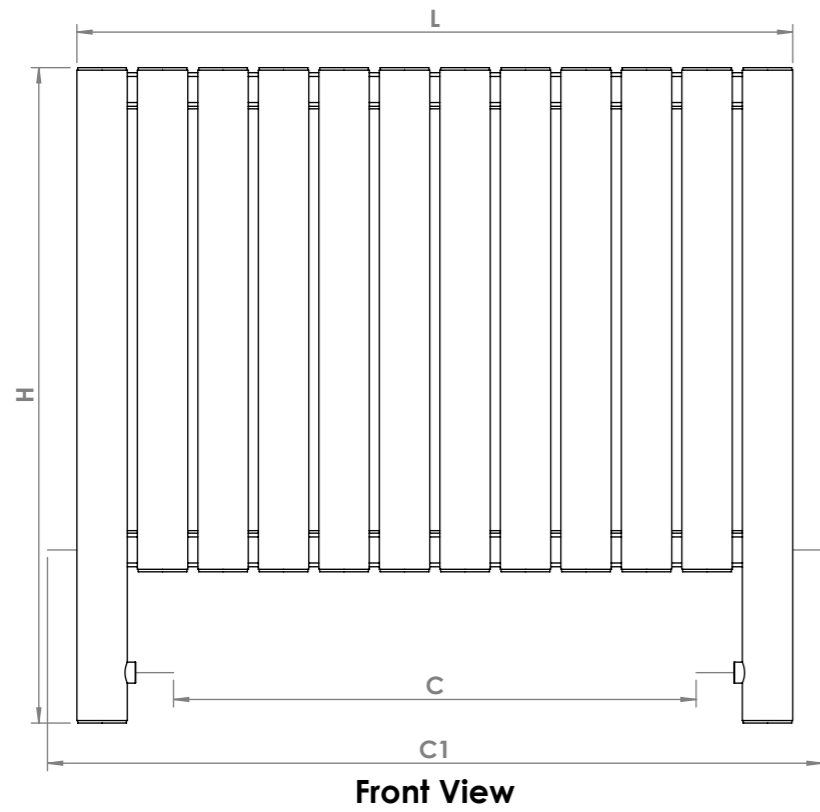
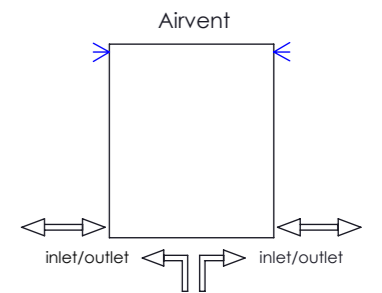

Vertical mount
 All Dimensions are in mm
 Max. Working Pressure: 10 Bar
 Max. Working Temperature: 95° C
 Inlet / Outlet : 1/2" BSP
 Fuel : E/H/D

Installation Accessories:

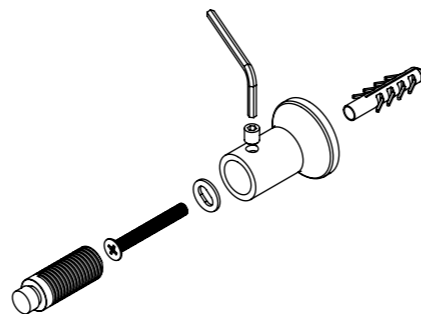
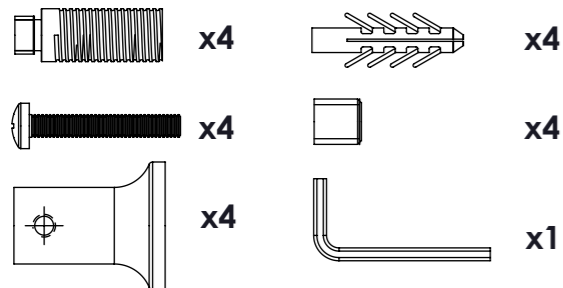

PRODUCT CODE	Height	Length	Depth	Pipe Centres	Bracket Centres	
	H mm	L mm	D mm	C-C1 mm	F mm	S mm
MYL808	780	550	90	320-620	470	490
MYL809	780	620	90	390-690	470	560
MYL810	780	690	90	460-760	470	630
MYL812	780	830	90	600-900	470	770
MYL814	780	970	90	740-1040	470	910
MYL816	780	1110	90	880-1180	470	1050
MYL820	780	1390	90	1160-1460	470	1330