

Front View

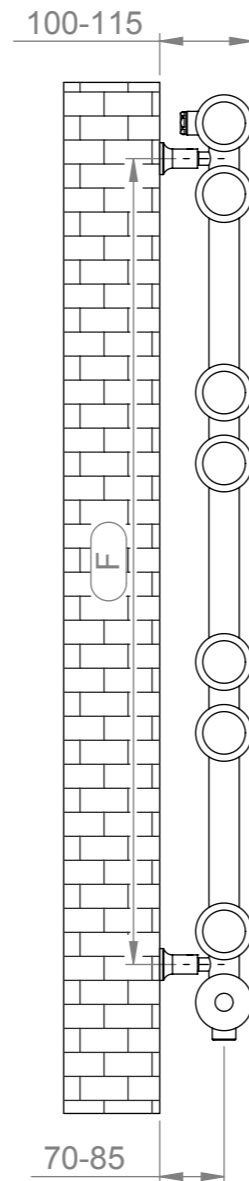

Side View

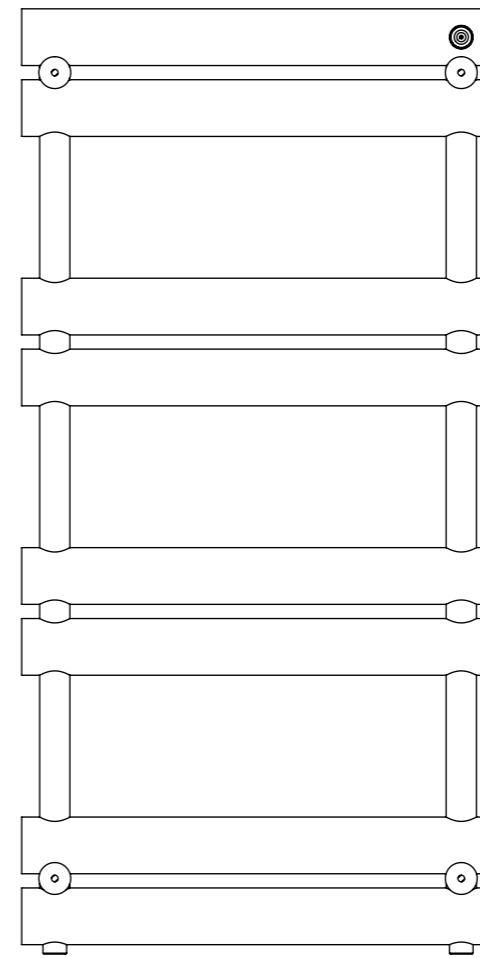

Back View

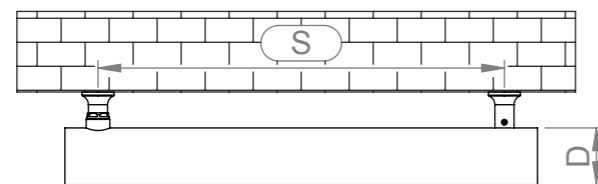
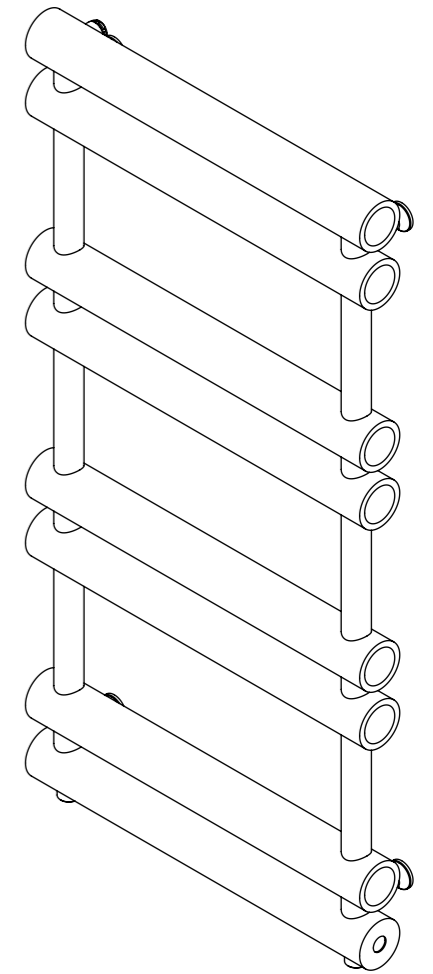

Top View

**Installation Accessories:**

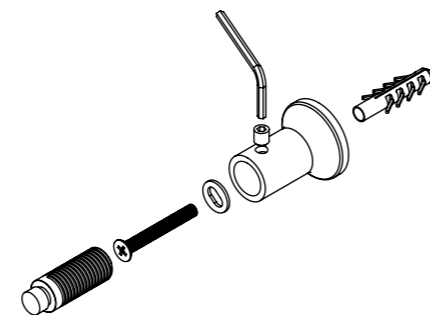
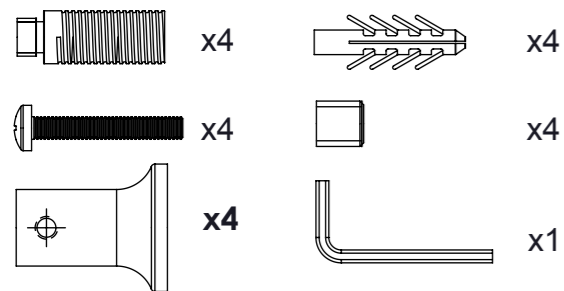

**Plumbing Position:**

Vertical mount  
 All Dimensions are in mm  
 Max. Working Pressure: 10 Bar  
 Max. Working Temperature: 95° C  
 Inlet / Outlet : 1/2" BSP  
 Fuel : E/H/D

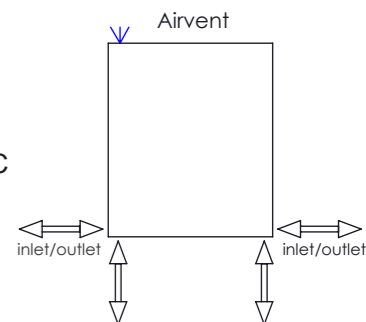

Manufacturing Tolerance : - 5 mm

PRODUCT CODE	Height	Length	Depth	Pipe Centres	Bracket Centres	
	H	L	D	C-C1	F	S
	mm	mm	mm	mm	mm	mm
TUB506	705	500	60	430-600	570	430
TUB508	990	500	60	430-600	835	430
TUB510	1275	500	60	430-600	565-565	430
TUB512	1560	500	60	430-600	855-565	430